

Tools required:
#2 Phillips Drive Screw driver or #2 Square bit drive

Parts Included:
(1) Cord Tray
(4) #10 x 3/4" Long Pan Head Phillips Drive Recex Screws
(2) #10-24 x 7/8" Long Pan Head Phillips Drive Machine Screws

- 2** From underneath the worksurface, align cord tray with pre-drilled holes in worksurface.

Once aligned, fasten (4) #10 x 3/4" Long Pan Head Phillips Drive screws into the front (4) four locations (See Fig. A).

Finish attachment by placing and attaching last two (2) #10-24 x 7/8" Long Pan Head Phillips Drive Screws into the back side of cord tray (See Fig. B)

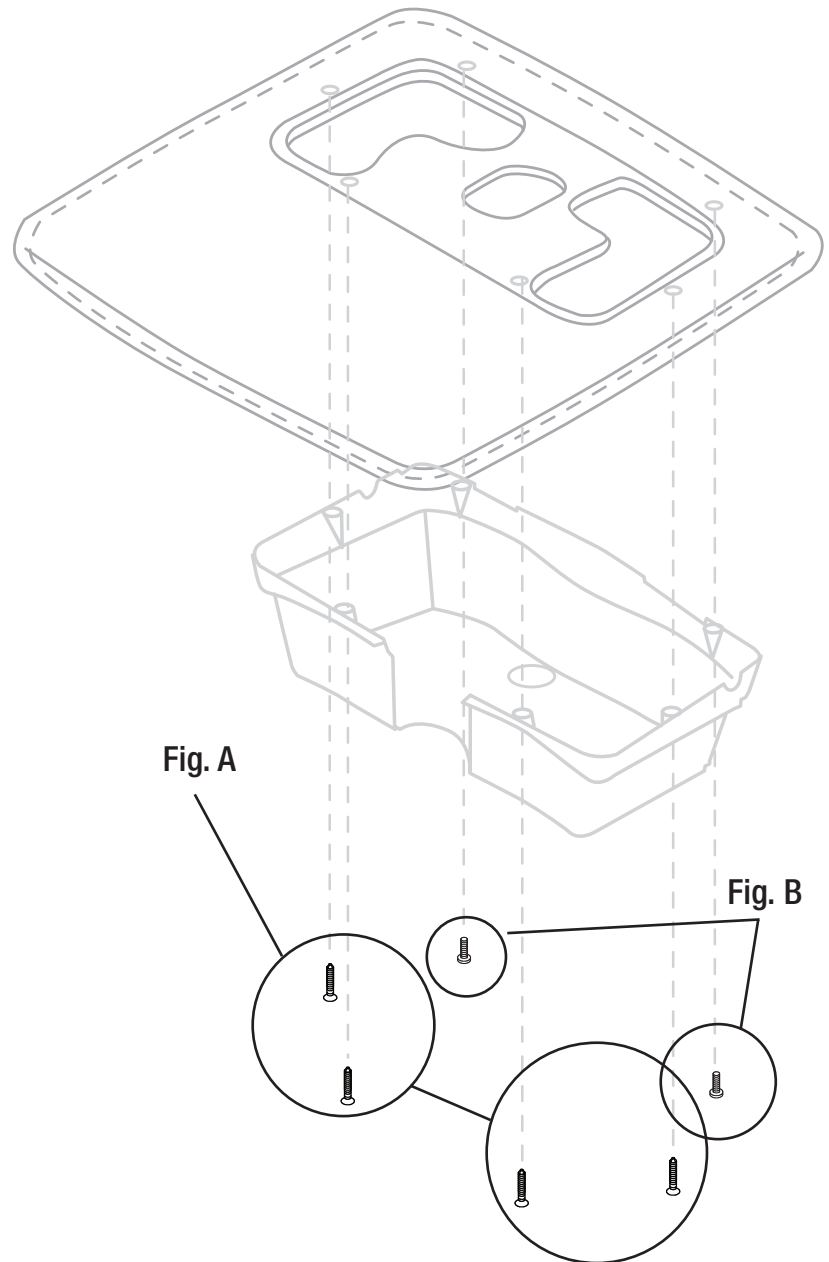

Tools required:
#2 Phillips Drive Screw driver or #2 Square bit drive

Parts Included:
(1) Cord Tray
(4) #10 x 3/4" Long Pan Head Phillips Drive Recex Screws
(2) #10-24 x 7/8" Long Pan Head Phillips Drive Machine Screws

I Before installing the cord tray, run all cables through allotted grommet holes. They may have to be installed in reverse due to the size of cable ends.

Fig. C shows the grommet hole for the following:

3-plug outlet cable
AC-In Cable
Grey cat. 5 cable
Black cat. 5 cable
USB cable

Fig. D shows (2) entry ways (one needed) for the coiled power cord.

Once all cables have been installed within the cord tray, proceed to install tray to worksurface.

